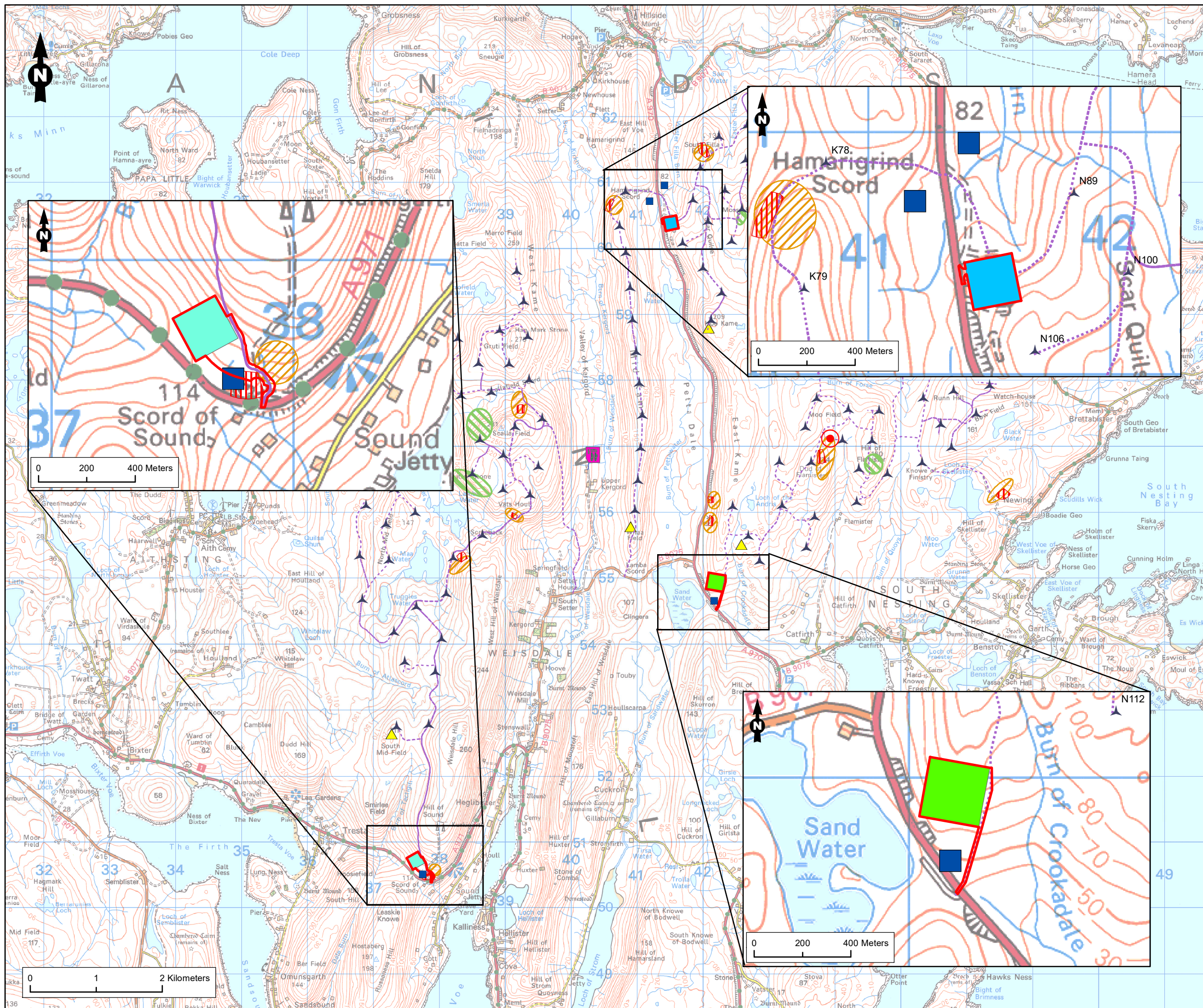

**FIGURE 3 – CONSTRUCTION COMPOUNDS IN RELATION TO VIKING WIND FARM**





- ### Legend
- Site Boundary
  - ▲ Turbines
  - Access Tracks
  - ▲ Permanent Met Masts
  - Substation
  - Converter Station Platform
  - Converter Station
  - Converter Station Access
  - Borrow Pit Extraction Area
  - Borrow Pit Search Area
  - Secondary Borrow Pit Search Area
  - Consented Construction Compound
  - Proposed Main Construction Compound (250m x 250m)
  - Proposed North Construction Compound (200m x 200m)
  - Proposed West Construction Compound (200m x 200m)

Note: The three Site Boundaries presented are separate from each other. Each shall have separate planning applications and will be assessed through separate Environmental Impact Assessment Reports.

Figure Title  
Figure 3: Construction Compounds in relation to Viking Wind Farm

Project Name  
Viking Wind Farm Construction Compounds - EIA Report

Project Number 1700001846	Figure No. 3
Date June 2019	Prepared By FB/AC
Scale 1:55,000 @A3	Issue 7

Client





## **FIGURE 4 – INDICATIVE DETAILED DESIGN DRAWING**

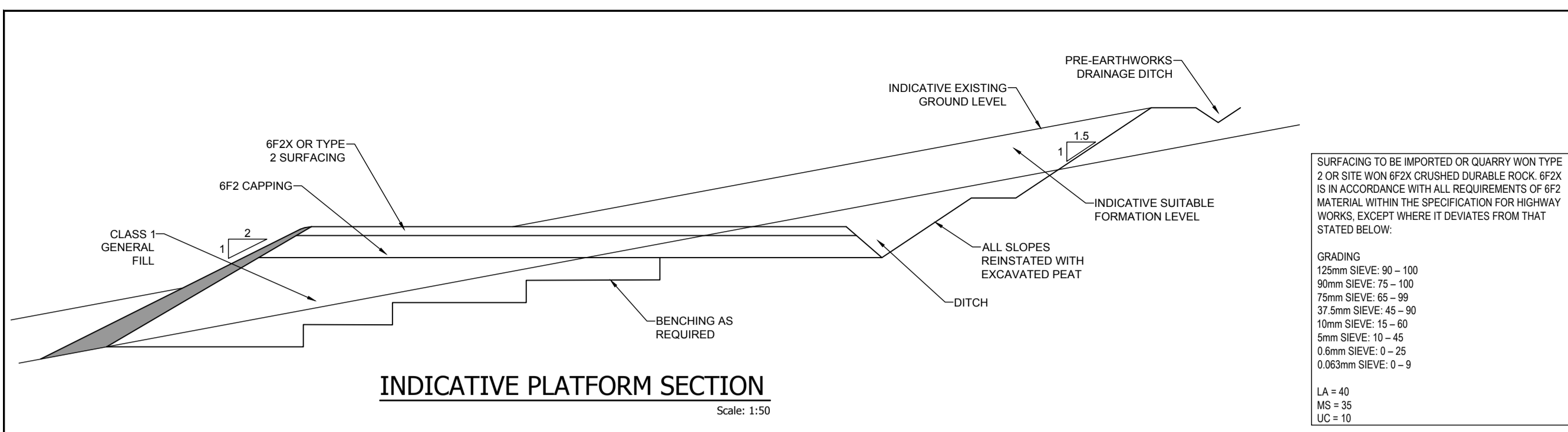
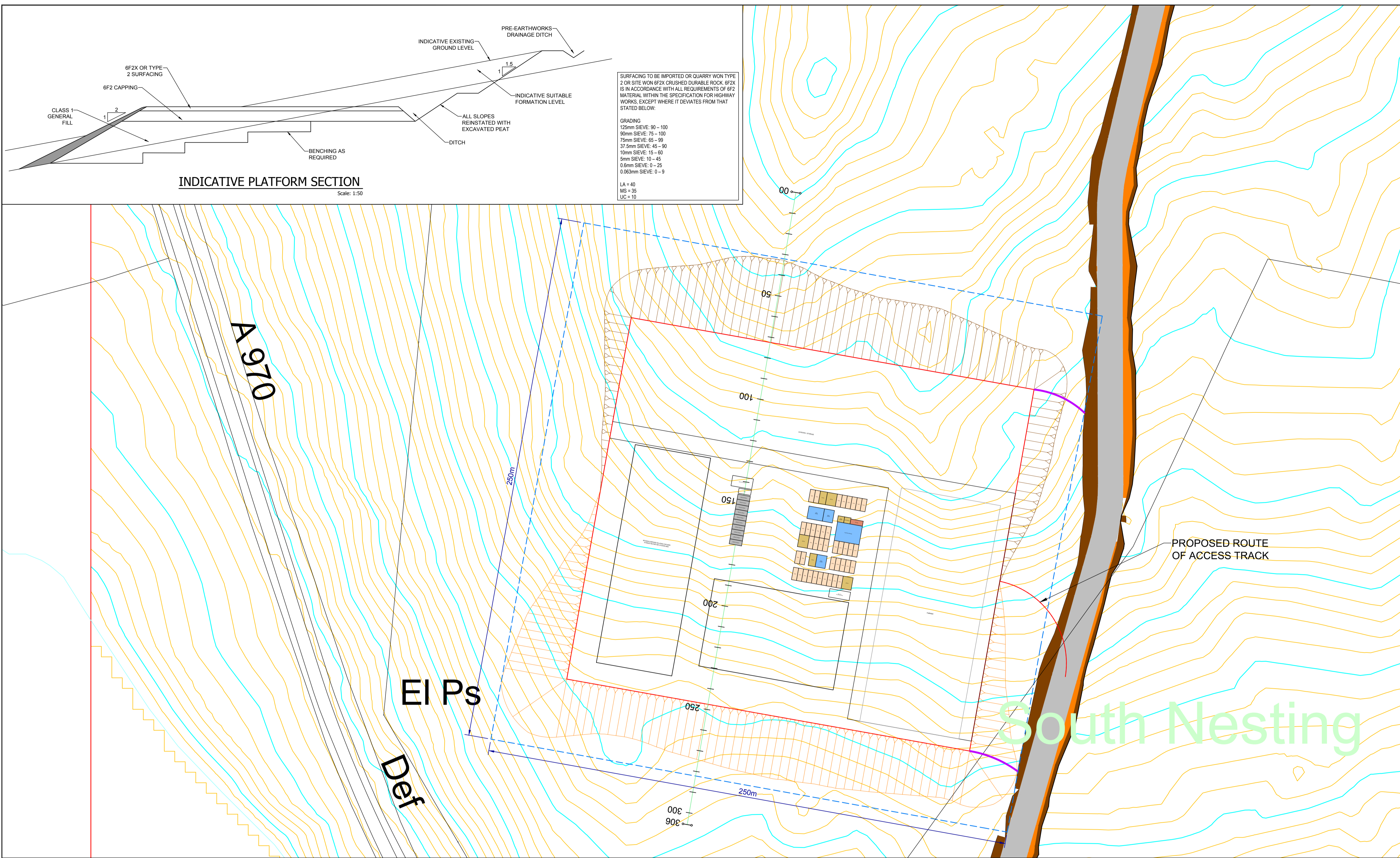

SURFACING TO BE IMPORTED OR QUARRY WON TYPE 2 OR SITE WON 6F2Z CRUSHED DURABLE ROCK. 6F2Z IS IN ACCORDANCE WITH ALL REQUIREMENTS OF 6F2 MATERIAL WITHIN THE SPECIFICATION FOR HIGHWAY WORKS, EXCEPT WHERE IT DEVIATES FROM THAT STATED BELOW:

GRADINGS  
 125mm SIEVE: 90 - 100  
 90mm SIEVE: 75 - 100  
 75mm SIEVE: 65 - 99  
 37.5mm SIEVE: 45 - 89  
 10mm SIEVE: 15 - 60  
 5mm SIEVE: 10 - 45  
 0.6mm SIEVE: 0 - 25  
 0.063mm SIEVE: 0 - 9

LA = 40  
 MS = 35  
 LC = 10

- LEGEND**
- COMPOUND SEARCH AREA
  - INDICATIVE SSE COMPOUND AREA
  - CUT
  - FILL

- NOTES**
1. DIMENSIONS ARE IN METRES.
  2. PLATFORM EARTHWORKS DESIGN AND LAYOUT INDICATIVE ONLY. FINAL DESIGN BY VIKING CIVIL CONTRACTOR.
  3. FENCING TO BE PROVIDED TO SECURE COMPOUND(S) BY CIVIL CONTRACTOR (MAX 2.5m TALL).
  4. DRAINAGE DESIGN BY CIVIL CONTRACTOR AND AGREED WITH SEPA AND LOCAL AUTHORITY.
  5. CABINS MAY BE DOUBLE STACKED (MAX 7m TALL).
  6. CONNECTION FOR PRIVATE WATER SUPPLY TO BE AGREED WITH LOCAL AUTHORITY. CONNECTION FOR MAINS WATER SUPPLY TO BE AGREED WITH SCOTTISH WATER.
  7. TOWER LIGHTING TO BE PROVIDED AS REQUIRED.
  8. WHEEL-WASH FACILITIES TO BE PROVIDED.

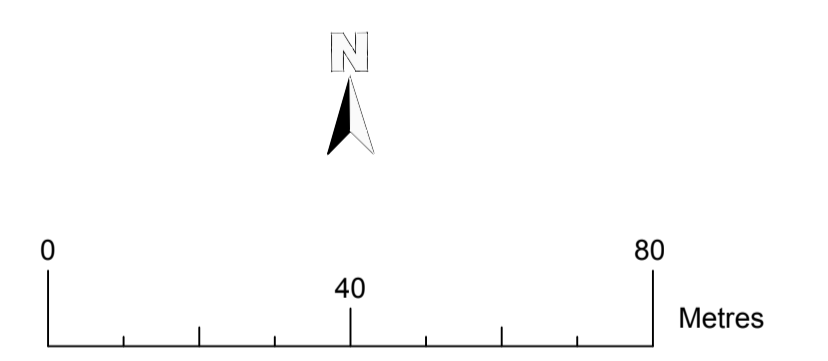

**MAINCOMPOUND1 - LONGSECTION**  
 SCALE: H 1:1000,V 1:1000. DATUM: 65.000

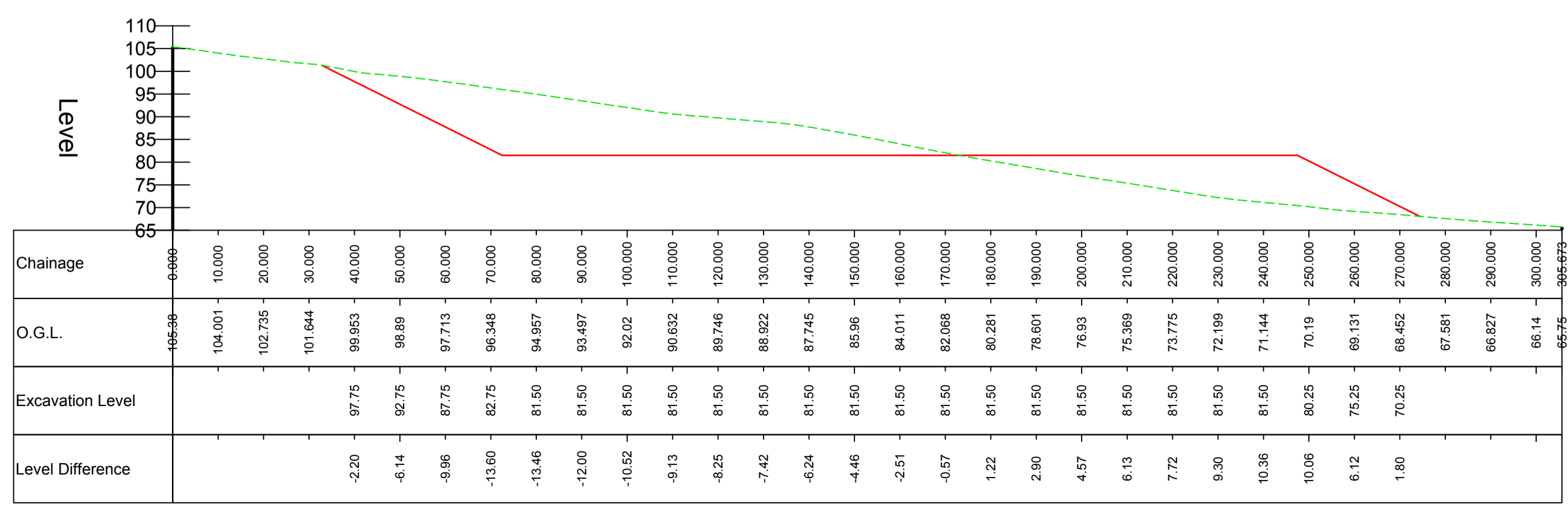

Rev	Rev. Date	Purpose of revision	Dm	Chkd	Appd
R0	21/05/19	FIRST ISSUE.			



Project		<b>VIKING WIND FARM</b>	
Title		<b>INDICATIVE MAIN COMPOUND</b>	
Drawing status		<b>FOR INFORMATION</b>	
Scale	1:1000 @ A1	Lower Left Coord	-
		Upper Right Coord	-
Drawing number	<b>MAIN COMPOUND</b>		Revision
			<b>R0</b>

© Crown copyright and database rights 2017 Ordnance Survey 100034570



